

**TOTAL EXTENT (AS PER PATTI)** : 3350 SQ.M ✓  
**ROAD AREA** : 1147 SQ.M ✓  
**NO.OF.PLOTS** : 28 Nos. ✓

**NOTE:**

- 1.SPLAY - 1.5M X 1.5M
- 2.MEASUREMENTS ARE INDICATED EXCLUDING SPLAY DIMENSION
3.  ROAD AREA WAS HANDED OVER TO THE LOCAL BODY  
 VIDE GIFT DEED DOCUMENT NO. 7737 / 2018, DATE: 24.12.2018, @ SRO PADAPPAI

**CONDITION :**

**DR RULE NO : 29 (11)**

THE COST OF LAYING IMPROVEMENTS TO THE SYSTEMS IN RESPECT OF ROAD, WATER SUPPLY, SEWERAGE, DRAINAGE OR ELECTRIC POWER SUPPLY THAT MAY BE REQUIRED AS ASSESSED BY THE COMPETENT AUTHORITY SHALL BE BORNE BY THE APPLICANT.

**LEGEND :**

-  SITE BOUNDARY ✓
-  ROADS GIFTED TO LOCAL BODY ✓
-  EXISTING ROAD ✓

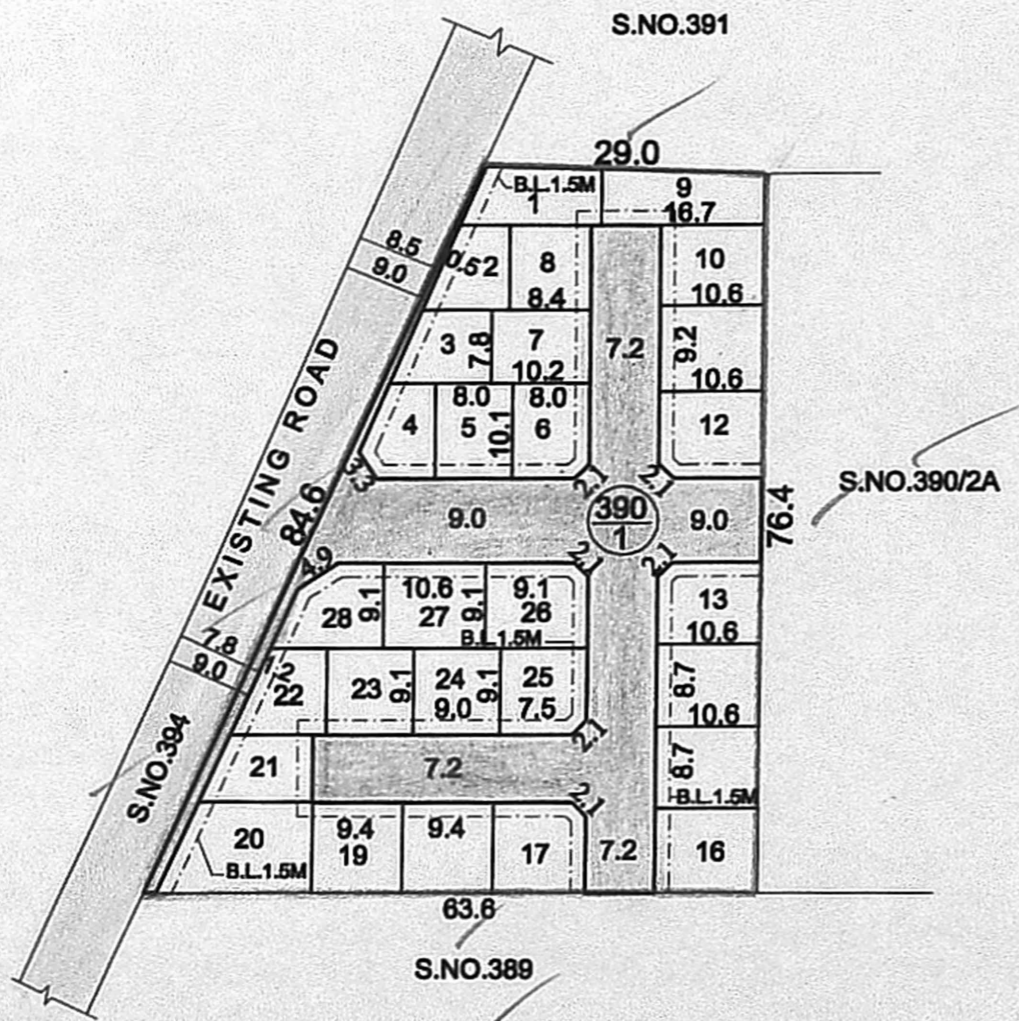

**CONDITION:-**  
 THE LAYOUT APPROVAL IS VALID SUBJECT TO OBTAINING SANCTION FROM THE LOCAL BODY CONCERNED

**P.P.D** NO 15  
**L.O** 2019  
**APPROVED**  
 VIDE LETTER NO : L1/14307/2018 ✓  
 DATED : 5 / 02 / 2019

*5/2/19*  
 FOR MEMBER SECRETARY  
 CHENNAI METROPOLITAN  
 DEVELOPMENT AUTHORITY 4/5

*S. Anantha P.A.II 4/2/19*  
 PREPARED BY  
*H/2/19*  
 P.A.II  
*AP 04/02/2019*

**KUNDRATHUR PANCHAYAT UNION**  
**LAYOUT OF HOUSE SITES IN S.No.390/1 OF VARADHARAJAPURAM VILLAGE.**  
 SCALE-1:800 (ALL MEASUREMENTS ARE IN METRE)

